



VESTIL MANUFACTURING CORP.

2999 North Wayne Street, P.O. Box 507, Angola, IN 46703

Telephone: (260) 665-7586 -or- Toll Free (800) 348-0868

Fax: (260) 665-1339

www.vestilmfg.com e-mail: info@vestil.com

SBRL-SERIES SPREADER BEAMS INSTRUCTION MANUAL

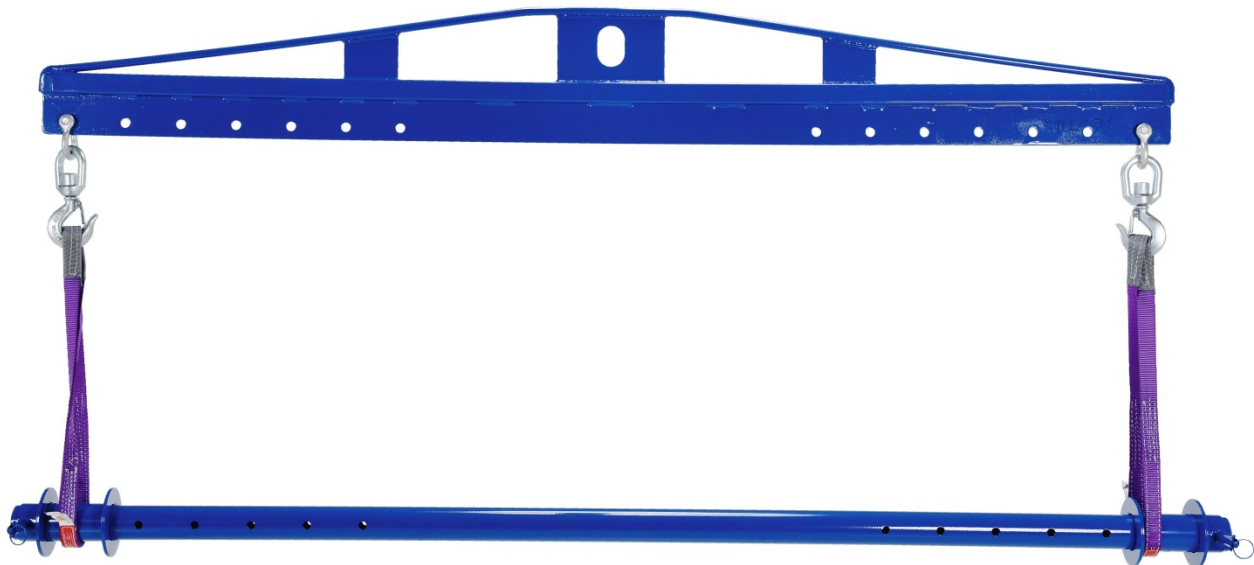

Receiving instructions:

After delivery, remove the packaging from the product. Inspect the product closely to determine whether it sustained damage during transport. If damage is discovered during the inspection, immediately record a complete description of the damage on the bill of lading. If the product is undamaged, discard the packaging.

NOTE:

The end-user is solely responsible for confirming that product design, installation, use, and maintenance comply with laws, regulations, codes, and mandatory standards applied where the product is *used*.

Table of Contents

Signal Words.....	2
Safety Guidelines.....	2 – 3
SBRL-25 Exploded parts diagram, bill of materials, & specifications.....	4
SBRL-40 Exploded parts diagram, bill of materials, & specifications.....	5
SBRL-80 Exploded parts diagram, bill of materials, & specifications.....	6
Using the roll lifter.....	7 – 9
Inspections	9
Labeling diagram	9
Limited warranty.....	10

Signal Words:

This manual uses SIGNAL WORDS to identify situations likely to result in personal injury or property damage. These words also indicate the seriousness of those injuries. Signal words used in this manual appear below along with their definitions.



Identifies a hazardous situation which, if not avoided, **WILL** result in **DEATH** or **SERIOUS INJURY**. Use of this signal word is limited to the most extreme situations.



Identifies a hazardous situation which, if not avoided, **COULD** result in **DEATH** or **SERIOUS INJURY**.



Indicates a hazardous situation which, if not avoided, **COULD** result in **MINOR** or **MODERATE** injury.



Identifies practices likely to result in product/property damage, such as operation that might damage the product.

Safety Guidelines

VESTIL strives to identify foreseeable hazards associated with the use of its products. However, material handling is inherently dangerous and no manual can address every conceivable risk. The end-user ultimately is responsible for exercising sound judgment at all times.

WARNING If this product is used improperly or carelessly, the user and/or bystanders might sustain serious personal injuries or even be killed. Therefore, ***each person who assembles, uses or maintains this lifting device should read and understand the entire manual before installing, using or servicing the product for the first time. Failure to do so is a misuse of the product. If you do not understand an instruction, ask your supervisor for clarification.*** Read the manual to refresh your understanding of proper use and maintenance procedures when necessary.

To reduce the likelihood of injury:

- **ALWAYS** inspect the spreader beam before each use according to the inspection procedures described in the most recent revision of ASME B30.20.
- Consult the safety messages included in the manuals for your crane, trolley, hoist, and any other device used in conjunction with this spreader beam.
- Always make sure that the shackle pin (see Item 4, “Shackle”, in Exploded Parts Diagrams on p. 3-5) is secure before applying a load to the load hook. Tighten the pin before each use.
- **BEFORE** releasing the roll material, be certain that it is fully supported by the ground or other surface, and is fully immobilized (can't fall over, roll, slide, or move in an uncontrolled manner). If a second person is needed to immobilize the material, find someone to help you.
- **ALWAYS** attach the spreader beam to a **safety hook** (e.g. a hoist that has a safety hook attached to the end of the chain or cable), or to a connection that includes safety mechanisms to prevent accidental/unintended detachment from the hoist. **DO NOT** use the device on a hoist hook that might accidentally/unintentionally release the clamp. **DO NOT** connect the beam to a safety hook that does not function properly or that is damaged.
- **Clear all debris**, including fluids, from the path of travel if the job requires moving the material to a new location **BEFORE** picking up the load. If moisture is present in the path of travel, absorb it before using the clamp.
- **DO NOT** remove or obscure any label. Verify the placement and legibility of all labels as shown in the label placement diagram on p. 9. If a label is damaged or unreadable, immediately contact Vestil for a replacement. **DO NOT** use the beam **UNLESS** all labels are securely attached and readable.
- **DO NOT** attempt an unbalanced lift. Before lifting a roll, confirm that it is properly balanced. (See “Using the Lifter,” on p. 9.
- **DO NOT** lift more than 1 roll at a time.
- Only lift rolls from the horizontal position.
- **DO NOT** sit on or apply any weight/pressure to the material held by the clamp.
- **DO NOT** attempt to lift material that weighs more than the rated load of the clamp. **ALWAYS** make sure that the material weighs no more than the rated load of the clamp.
- **DO NOT** lift a load higher than necessary.
- **DO NOT** walk beneath a raised load or allow other persons to do so.

⚠ WARNING (continued from p. 2)

- DO NOT use the spreader beam to lift material over people or to lift any apparatus that supports people, such as a work platform. The beam is designed ONLY to lift material on rolls.
- DO NOT get in front of or behind a suspended load while moving it. Always orient yourself so that the load is visible to you. You are less likely to be injured if the load remains within your sight at all times.
- DO NOT leave suspended material unattended. An unattended, suspended load creates a risk of injury to yourself and others. Always move the load to its desired location, set it down and properly immobilize it; then disengage the load.
- DO NOT attempt to resolve any problem with the product unless you are both authorized to do so and certain that it will be safe to use afterwards.
- Inspect the product before each use, as described in “Inspections & Maintenance Recommendations” on p. 9, to confirm normal condition. DO NOT use the product if any unusual noise or movement is observed. If a malfunction occurs, remove the unit from service and notify your supervisor & maintenance personnel about the issue.
- DO NOT exceed the capacity of this product (see “Product specifications” table below and “Label placement diagram” on p. 9).
- DO NOT modify the spreader beam or any component in any way UNLESS you first obtain written approval from Vestil. Unauthorized modifications automatically void the Limited Warranty (p. 10) and might make the beam unsafe to use.
- DO NOT use the lifting device UNLESS all product labels (see “Label placement diagram” on p. 9) are readable and undamaged.

NOTICE Proper use, maintenance, and storage are essential for this product to function properly.

- Always use this product in accordance with the instructions in this manual and consistent with any training relevant to hoists and rigging used in conjunction with this product.
- Keep the product clean & dry. Periodically lubricate moving parts.

SBRL-25: Exploded Parts Diagram, & Bill of Materials

Item	Part no.	Description	Qty.
1	08-514-225	SBRL-25 spreader frame weldment	1
2	08-014-168	SBRL-25 roll lifting shaft	1
3	08-514-226	Roll retainer with detent pins	2
4	08-145-010	Shackle with screw pin	2
5	08-145-001	2-ton hook	2

**Includes sling SL-2-F-4

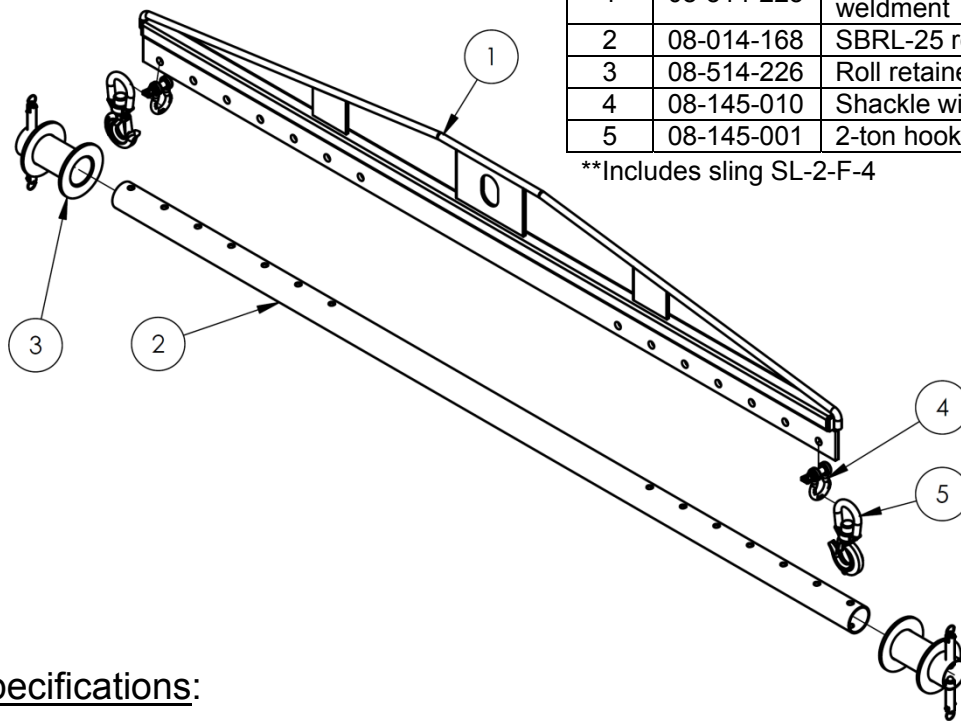

Specifications:

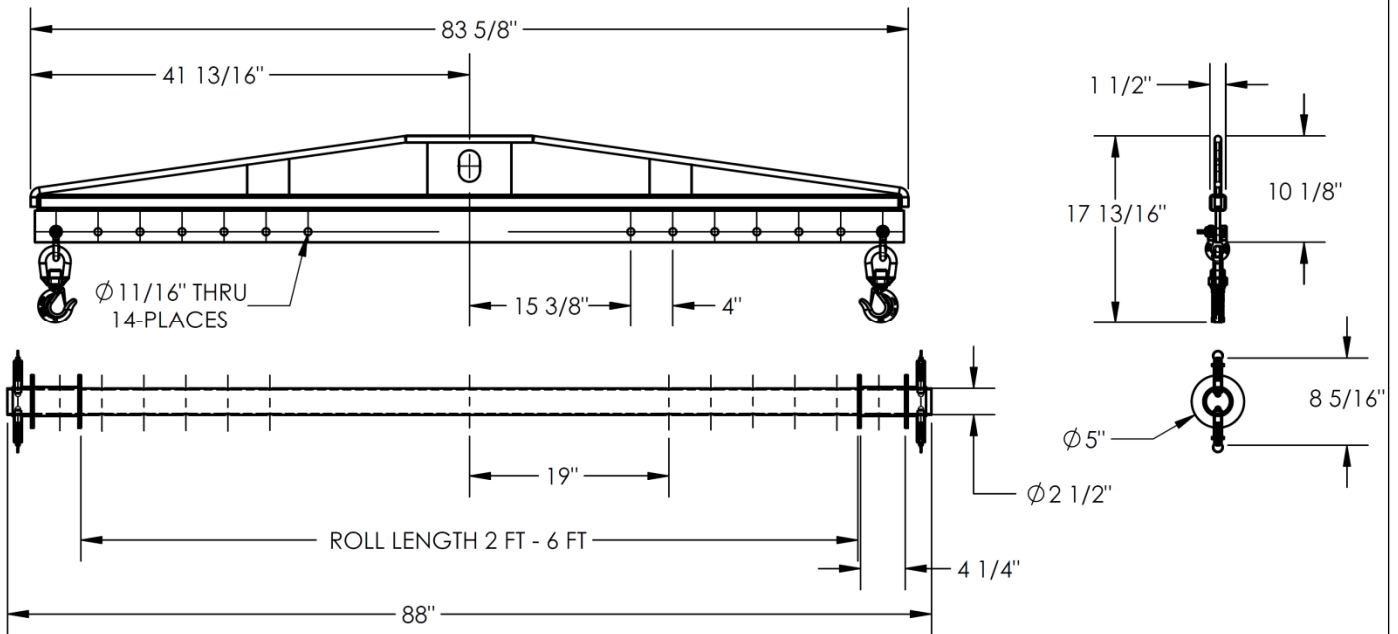

Model	Maximum roll length	Capacity	Net weight
SBRL-25	6 feet 1.8m	2,500lb. 1,136.4kg	88 lb. 40 kg

SBRL-40: Specifications, Exploded Parts Diagram, & Bill of Materials

Item	Part no.	Description	Qty.
1	08-514-227	SBRL-40 spreader frame weldment	1
2	08-014-171	SBRL-40 roll lifting shaft	1
3	08-514-226	Roll retainer with detent pins	2
4	08-145-010	Shackle with screw pin, 1/2", 2 ton	2
5	08-145-001	2-ton hook	2

**Includes sling SL-2-F-4

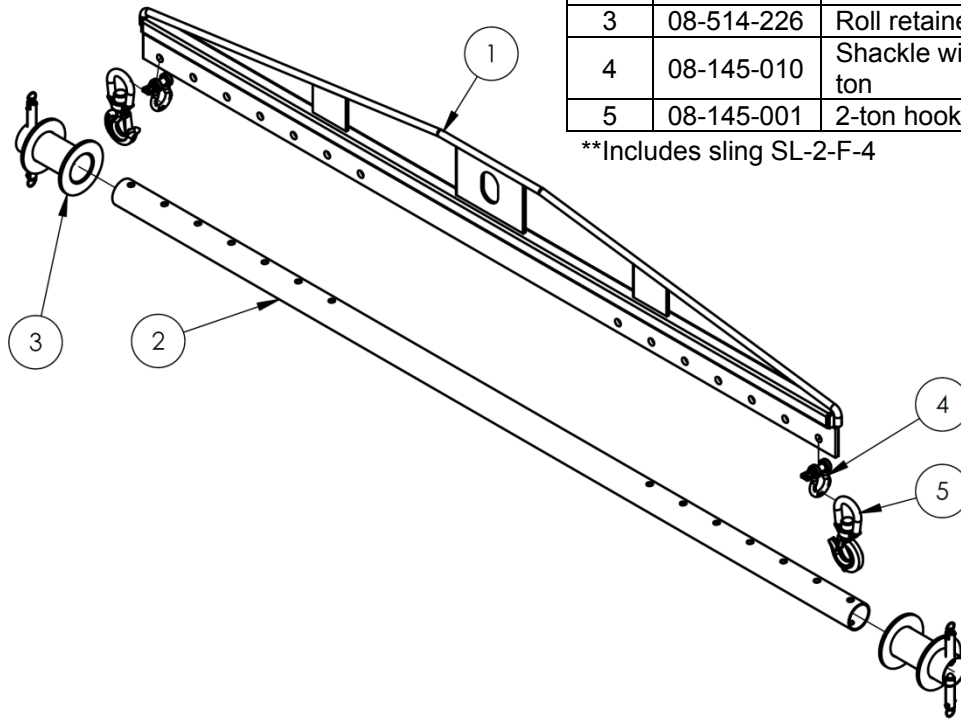

Specifications:

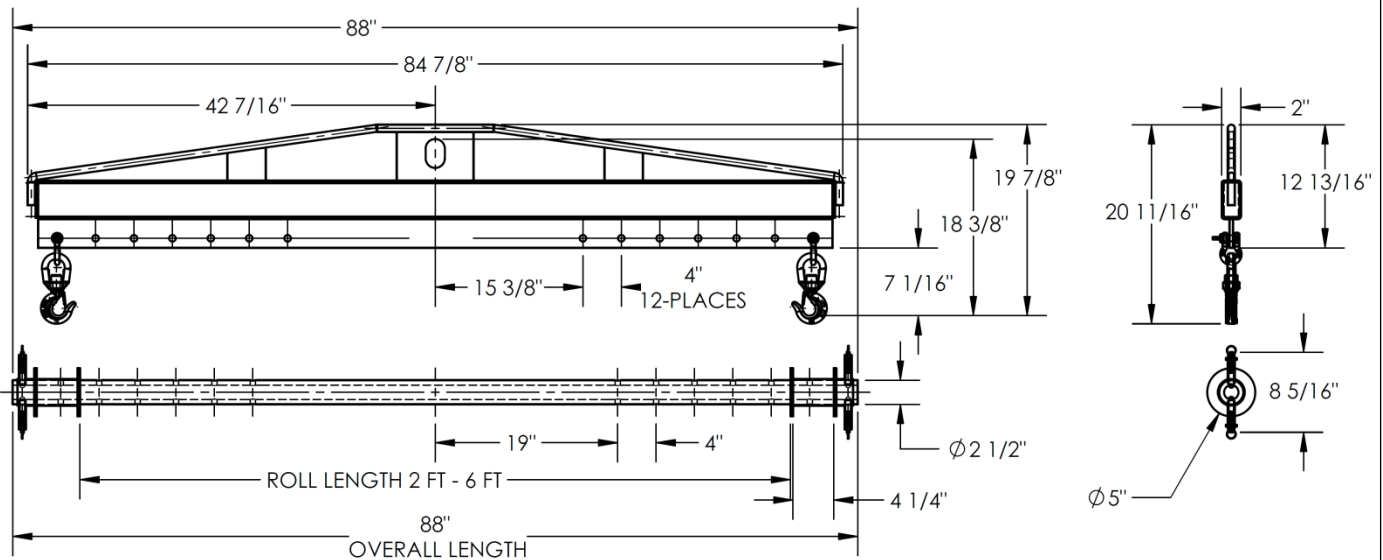

Model	Maximum roll length	Capacity	Net weight
SBRL-40	6 feet 1.8m	4,000 lb. 1818.2 kg	200 lb. 91 kg

SBRL-80: Specifications, Exploded Parts Diagram, & Bill of Materials

Item	Part no.	Description	Qty.
1	08-514-228	SBRL-80 spreader frame weldment	1
2	08-017-053	SBRL-40 roll lifting shaft	1
3	08-514-229	Roll retainer with detent pins	2
4	99-145-019	Shackle with screw pin	2
5	08-145-002	3-ton swivel hook	2

**Includes sling SL-4-F-4

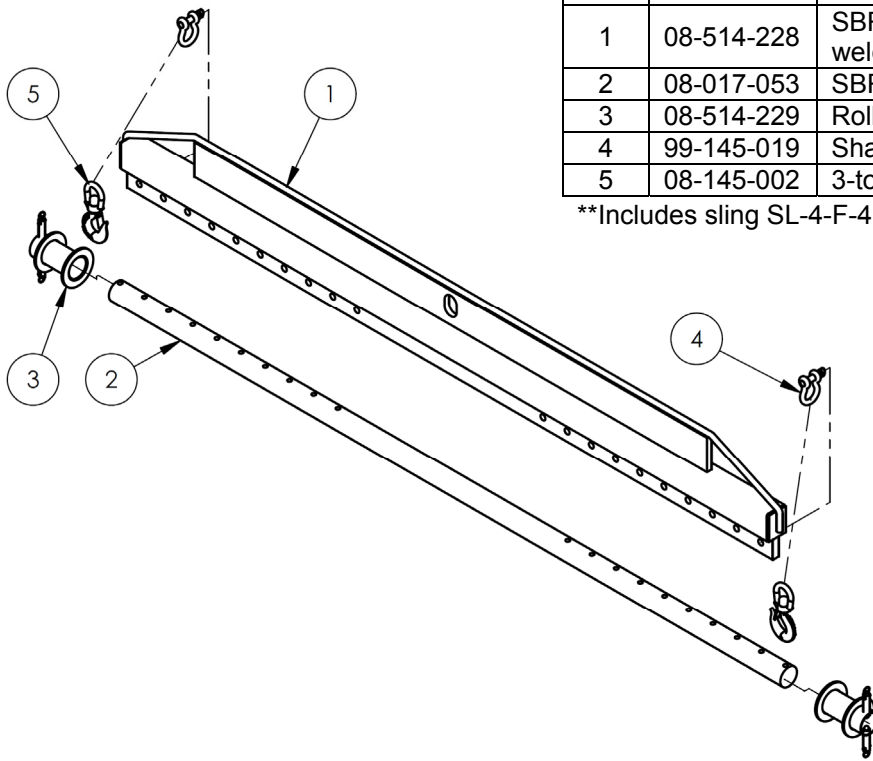

Specifications:

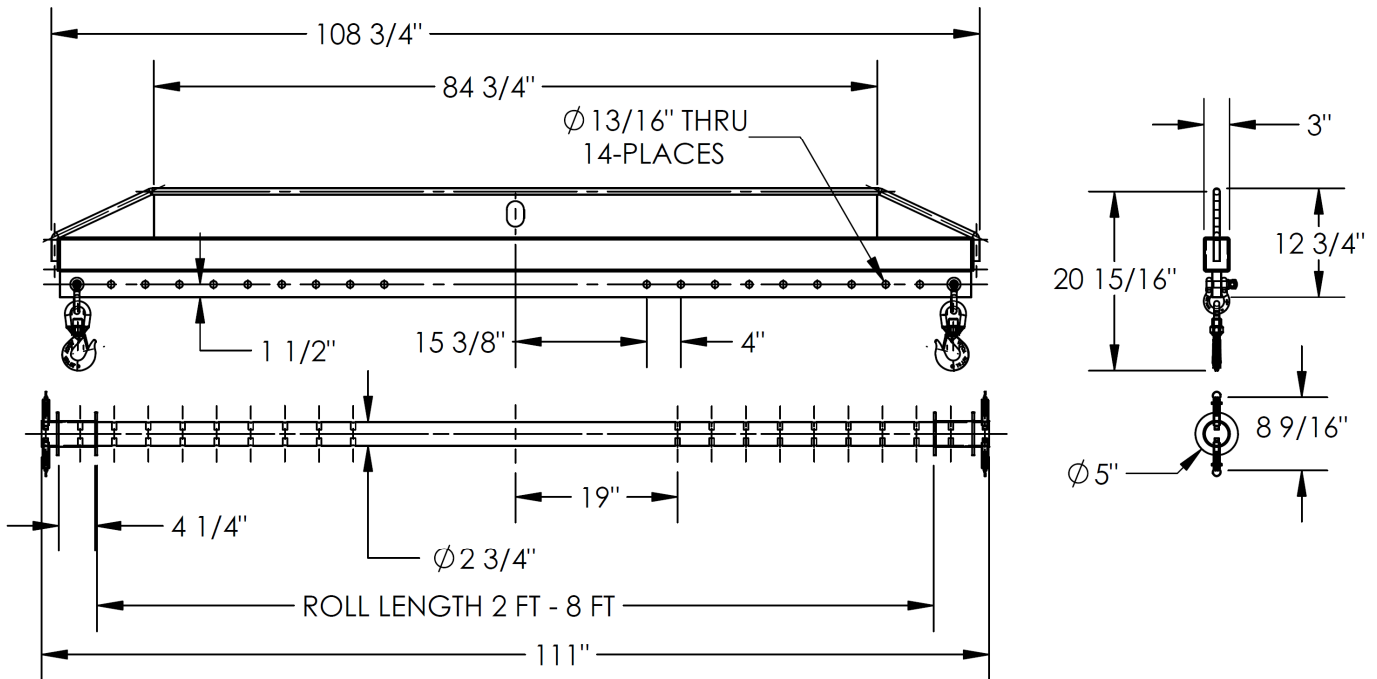

Model	Maximum roll length	Capacity	Net weight
SBRL-80	8 feet 2.4 m	8,000 lb. 3636.4 kg	489 lb. 222.3 kg

Using the roll lifter:

WARNING The capacity of the hoist should equal or exceed the capacity of the roll lifter. DO NOT exceed the capacity of the lifter or the hoist, whichever is smaller. The capacity of each roll lifter model is listed in the table on p. 3 and is displayed on label 287 (see "Label placement diagram" on p. 10).

1. Pull up/down on the detent pins (of the roll retainers); then slide the tubes off of the roll lifting shaft.

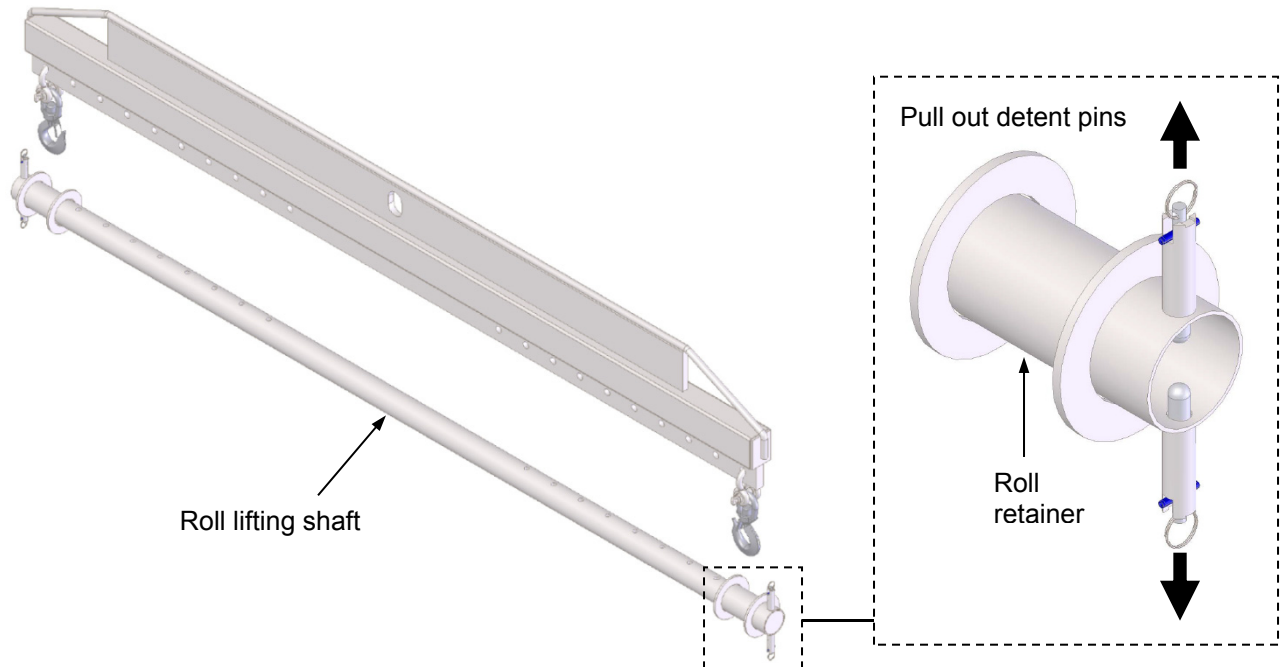

2. Insert the roll lifting tube through the roll. Adjust the position of the lifting shaft so that it is centered lengthwise inside the roll.

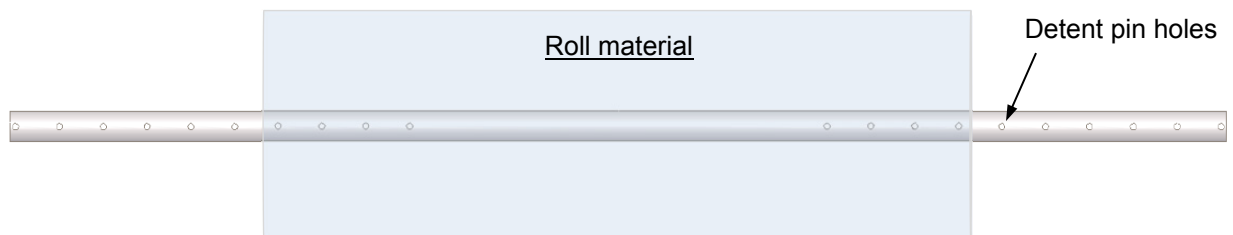

3. Install the retainers. Pull out the detent pins and slide a retainer onto each end of the roll lifting shaft. Press the retainers against the ends of the roll; then release the detent pins. Adjust the position of each retainer until the detent pins seat inside pin holes. Retainers should seat into place as close to the ends of the roll as possible.



4. Adjust the location of the hooks. Each hook should hang above the center of the sling channel of a retainer.

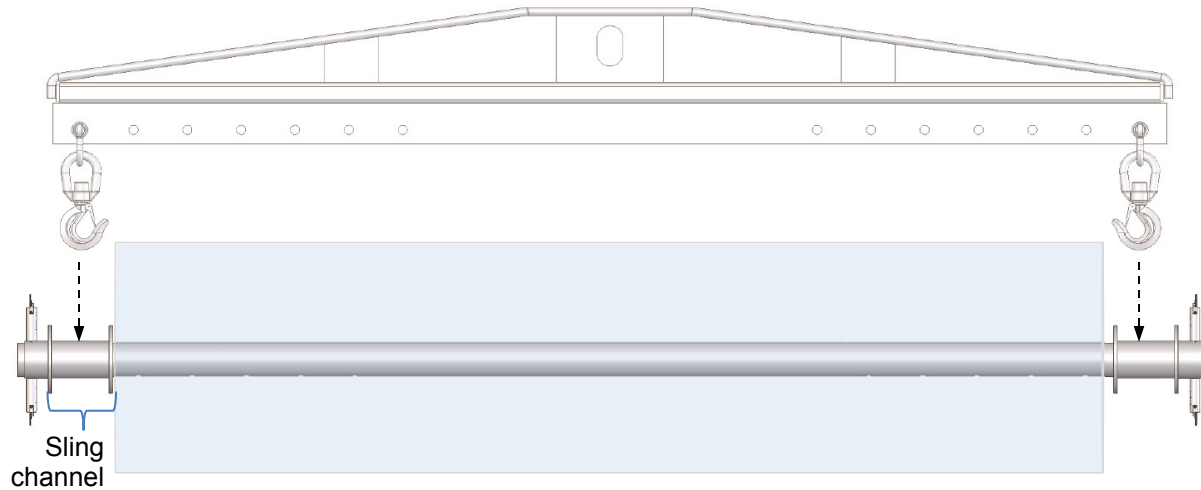

To change the position of a hook, remove the threaded pin from a shackle; then reattach the shackle to the spreader frame via the appropriate pin hole. Pin holes are 4 inches apart.

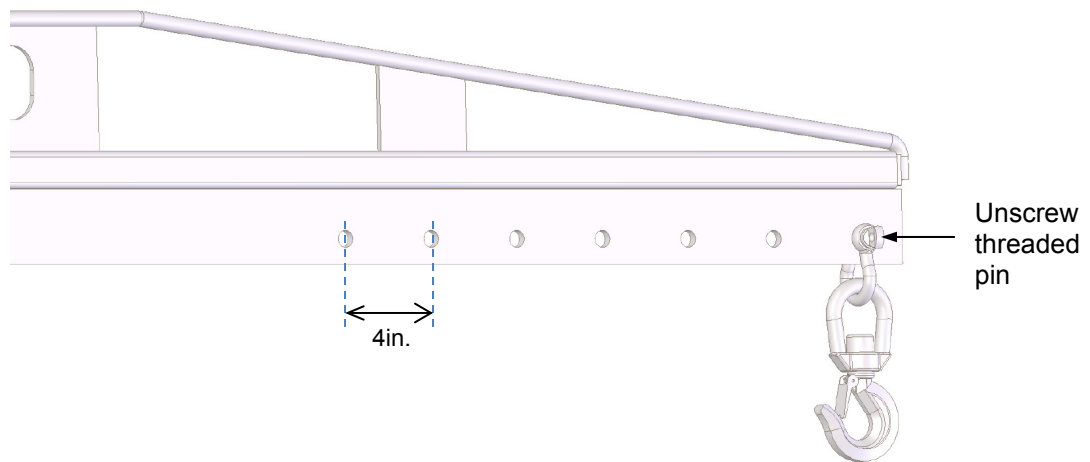

5. Attach one end of a sling to one of the hooks, wrap the sling around the sling channel of a retainer, and then attach the other end of the sling to the hook. Attach a second sling to the other hook in the same fashion.

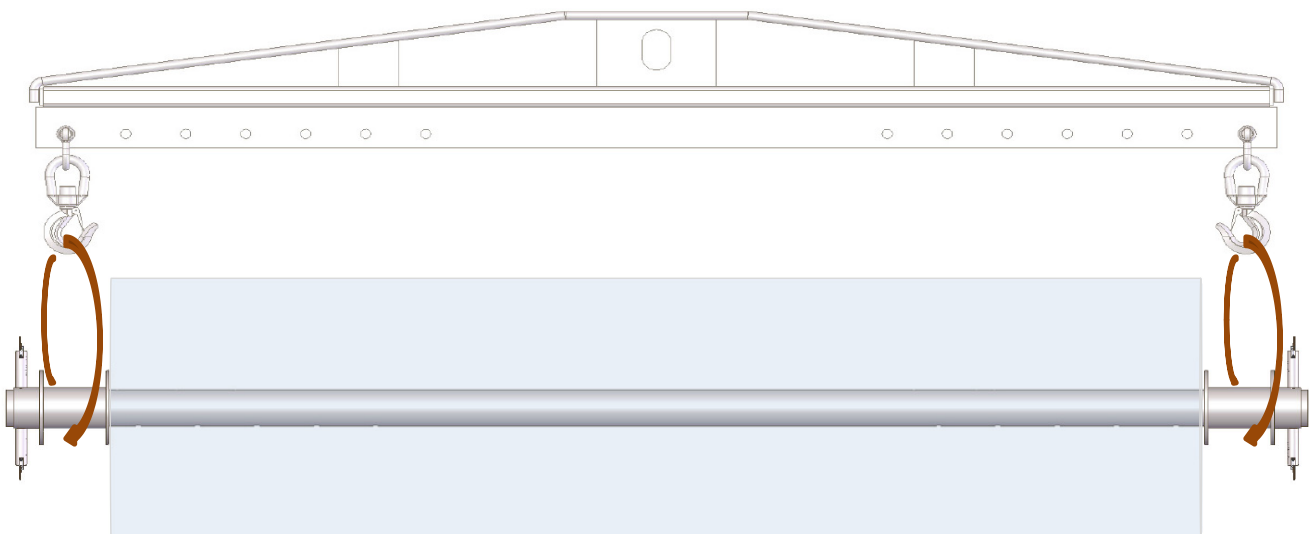

6. Raise the load a few inches above the ground and verify that it is properly balanced. If one end of the load is considerably lower than the other, return the load to the ground and reposition the retainers, hooks, and shackles. When properly balanced, the spreader beam and roll will be horizontal.

Inspections

NOTE: Perform the recommended inspections in ASME B30.20.

Inspect the spreader beam as frequently as indicated in this section to confirm that it is in normal operating condition. A designated person should verify that the spreader beam complies with all regulations, codes, and standards that apply to "Below-the-Hook Lifting Devices" in the location where the beam is *used*.

Before each use, inspect all of the components listed below. Do not use this lifting device unless ALL components are in normal condition:

1. Spreader frame assembly: Examine each pin hole for elongations and the surrounding metal for cracks, and severe rusting and corrosion. Pin holes should be smooth and circular; the frame should be square and rigid and should lack cracks, warps, regions weakened by severe rusting or corrosion, etc.
2. Roll lifting shaft: confirm that the shaft is straight and rigid. Also examine the pin holes through the shaft for flared areas, elongations, cracks, bends, and warps.
3. Pins: inspect all of the detent pins (of the roll retaining tubes) and all threaded pins (part of the shackles). Confirm that pins are straight and without cracks or warps.
4. Hooks and shackles (hardware): examine each hook and shackle for damage including excessive wear, warping, cracks, or deformation. Remove and replace a hook or shackle that is damaged;
5. Roll retainers: confirm that both retaining tubes are free of warps and cracks. Confirm that the detent pins are firmly connected to the retaining tubes.
6. Product labels: all labels should be readable and located as shown in the label placement diagram below. If a label(s) is unreadable or missing, contact Vestil to order a replacement.
7. Welds: confirm that all welds are intact.

Labeling diagram

Each spreader beam should be labeled as shown below. Replace any label that is missing, damaged, or unreadable. DO NOT use this product unless all labels are in place.

Label 287

MODEL/MODÉLO/MODÈLE	_____
CAPACITY	_____ lbs.
CAPACIDAD/CAPACITÉ	_____ kgs.
SERIAL/SERIE/SÉRIE	_____

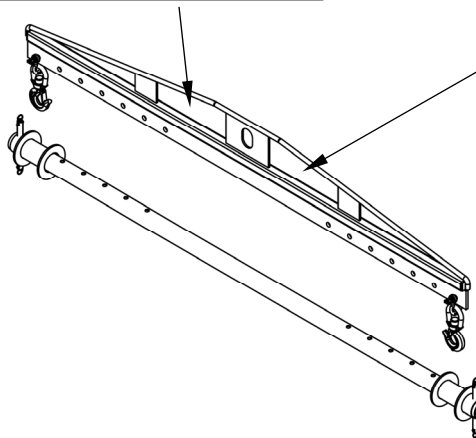

Label 675

⚠ WARNING	⚠ ADVERTENCIA
<ul style="list-style-type: none"> • DO NOT exceed rated capacity • DO NOT use if damaged, malfunctioning, or missing parts • DO NOT lift people OR lift loads over people • DO NOT raise load higher than necessary • DO NOT leave a suspended load unattended • DO NOT use lifter unless you read and understand the owner's manual • DO NOT alter OR modify lifter • DO NOT remove OR obscure any label • STAY CLEAR of suspended loads • Secure load before using this device 	<ul style="list-style-type: none"> • NO exceda la capacidad tasada • NO USE is las partes estan dañadas, no funcionan correctamente o faltan partes. • NO eleve al personal o eleve cargas sobre el personal • NO eleve la carga mas alto de lo necesario • NO deje desatendida una carga que este suspendida • NO use el elevador a no ser que haya leído y entendido las instrucciones del manual del propietario • NO altere o modifique el elevador • NO quite u oscurezca ninguna etiqueta • MANTENGASE alejado de las cargas suspendidas • Asegure la carga antes de usar este dispositivo

LIMITED WARRANTY

Vestil Manufacturing Corporation (“Vestil”) warrants this product to be free of defects in material and workmanship during the warranty period. *Our warranty obligation is to provide a replacement for a defective original part if the part is covered by the warranty, after we receive a proper request from the warrantee (you) for warranty service.*

Who may request service?

Only a warrantee may request service. *You are a warrantee if* you purchased the product from Vestil or from an authorized distributor AND Vestil has been fully paid.

What is an “original part”?

An original part is a part used to make the product as shipped to the warrantee.

What is a “proper request”?

A request for warranty service is proper if Vestil receives: 1) a photocopy of the Customer Invoice that displays the shipping date; AND 2) a written request for warranty service including your name and phone number. Send requests by any of the following methods:

Mail
Vestil Manufacturing Corporation
2999 North Wayne Street, PO Box 507
Angola, IN 46703

Fax
(260) 665-1339
Phone
(260) 665-7586

Email
sales@vestil.com

In the written request, list the parts believed to be defective and include the address where replacements should be delivered.

What is covered under the warranty?

After Vestil receives your request for warranty service, an authorized representative will contact you to determine whether your claim is covered by the warranty. Before providing warranty service, Vestil may require you to send the entire product, or just the defective part or parts, to its facility in Angola, IN. The warranty covers defects in the following original dynamic components: motors, hydraulic pumps, electronic controllers, switches and cylinders. It also covers defects in original parts that wear under normal usage conditions (“wearing parts”), such as bearings, hoses, wheels, seals, brushes, and batteries.

How long is the warranty period?

The warranty period for original dynamic components is 90 days. For wearing parts, the warranty period is 90 days. The warranty periods begin on the date when Vestil ships the product to the warrantee. If the product was purchased from an authorized distributor, the periods begin when the distributor ships the product. Vestil may, at its sole discretion, extend the warranty periods for products shipped from authorized distributors by up to 30 days to account for shipping time.

If a defective part is covered by the warranty, what will Vestil do to correct the problem?

Vestil will provide an appropriate replacement for any covered part. An authorized representative of Vestil will contact you to discuss your claim.

What is not covered by the warranty?

1. Labor;
2. Freight;
3. Occurrence of any of the following, which automatically voids the warranty:
 - Product misuse;
 - Negligent operation or repair;
 - Corrosion or use in corrosive conditions;
 - Inadequate or improper maintenance;
 - Damage sustained during shipping;
 - Accidents involving the product;
 - Unauthorized modifications: DO NOT modify the product IN ANY WAY without first receiving written authorization from Vestil. Modification(s) might make the product unsafe to use or might cause excessive and/or abnormal wear.

Do any other warranties apply to the product?

Vestil Manufacturing Corp. makes no other express warranties. All implied warranties are disclaimed to the extent allowed by law. Any implied warranty not disclaimed is limited in scope to the terms of this

